



Toe Board

Data Sheet v1.0



CableSafe® / Westmark B.V.
Arnhemseweg 87, 3832 GK Leusden



+31334614844



info@cablesafe.com

Dropped Objects Prevention Toe Board

FEATURES

- Neatly enclose field cut penetrations
- Great for rework
- Eliminates the need to weld banding or split oversize pipe
- Faster on fiberglass grating
- Uniform, finished appearance

INSTALLATION

- No hot work permit required
- No scaffolding required
- Installs from the top-side of grating
- Sandwich grating between hardware and T5
- Easy to install
- Just as fast and easy to remove

WIDESPREAD SUCCESS

- Proven design has been successfully used for over 20 years
- Specified by many multi-national industrial companies
- Recommended & used by many engineering & construction firms

MATERIAL & WEATHERABILITY

- Excellent outdoor weatherability
- In sunlight, material will surface discolor but not degrade
- No loss of tensile strength after 9 months in Arizona and Florida UV-exposure tests

BENEFITS

- Safe & effective
- Maintenance free
- Long service life
- Proven design
- Provides the protection you want
- Economical

CONSTRUCTION

- All molded parts are made from a strong, rigid, UV-resistant polyurethane
- Non-corrosive
- Molded parts colored throughout with safety yellow
- Supplied with galvanized hardware J-Bolt (T5-J)

Installation



Layout the T5 pieces around the pipe penetration, and insert the 3/8" x 3 1/2" long bolts through the connecting holes. Thread them, but do not tighten.



Drop J-bolts in the slots located on the bottom of each T5 piece. Catch one of the grating bars with the J-bolt and tighten. Do this for all T5 pieces.



Once all the J-bolts are securely fastened, tighten each of the 3/8" x 3 1/2" bolts in the connecting holes.

Dropped Objects Prevention Toe Board

One Link (T5) To Encircle All Pipe Sizes

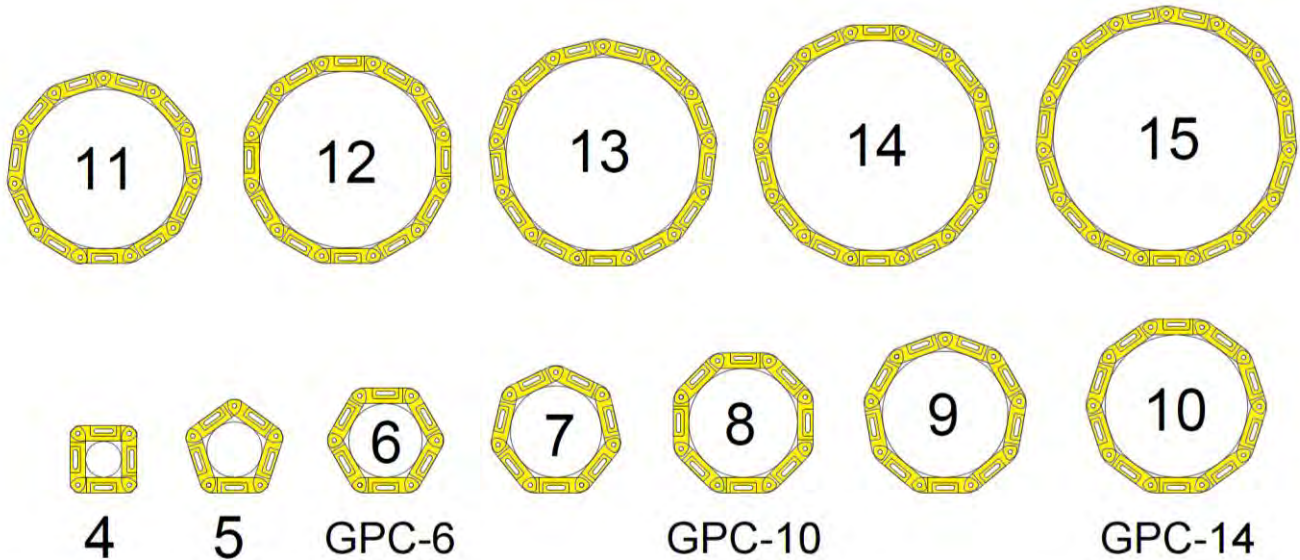

Used on most types of grating



1 Square Opening



3 Rectangular Opening

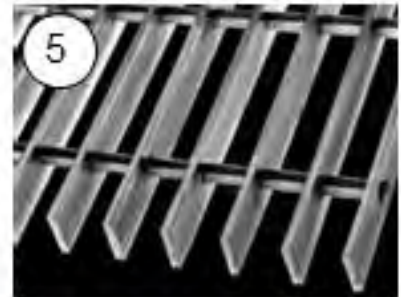

5 Rectangular Opening

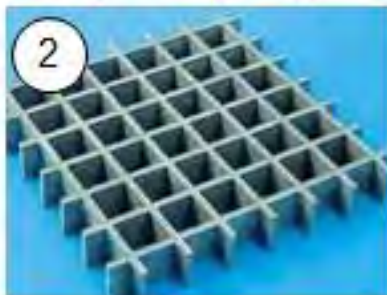

2



4



6

Dropped Objects Prevention Toe Board

Dimensions and layouts

| Number of T5 | Max. Inside Circle [mm] |
|--------------|-------------------------|
| 4 | 90 |
| 5 | 135 |
| 6 | 180 |
| 7 | 220 |
| 8 | 265 |
| 9 | 310 |
| 10 | 350 |
| 11 | 395 |
| 12 | 425 |
| 13 | 475 |
| 14 | 520 |
| 15 | 560 |

To Calculate T5 Links Needed For Larger Circular Enclosures

Round Up
The Result Of

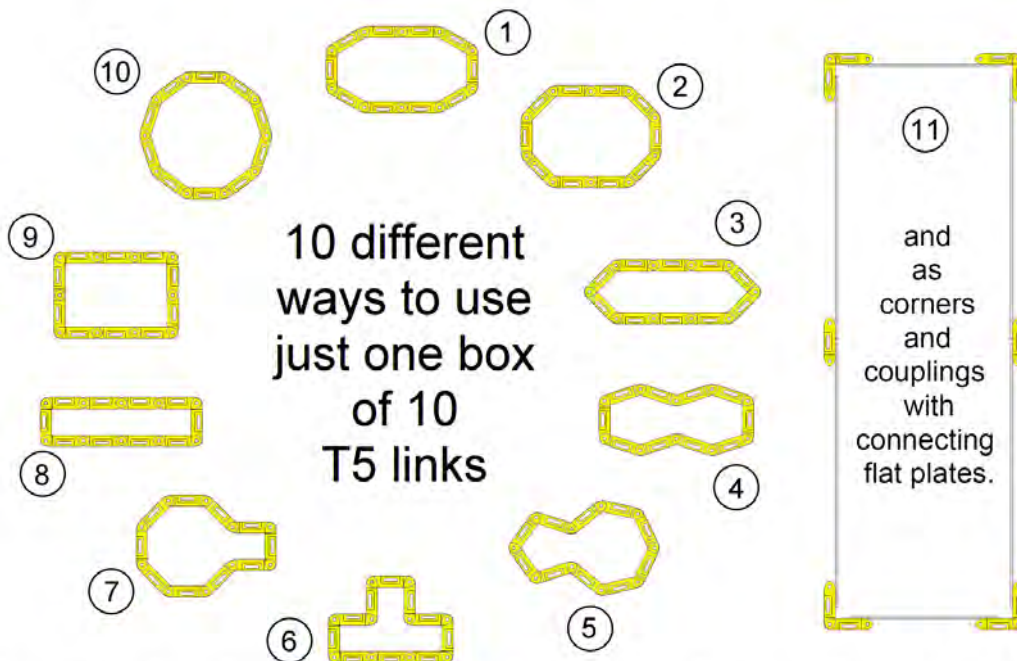
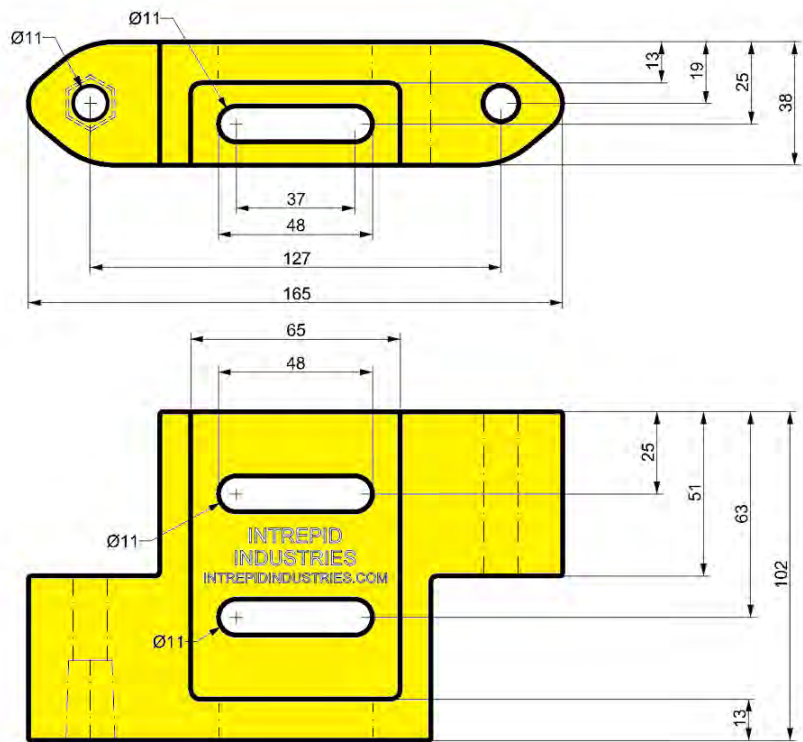
$$\frac{3.14 \times (\text{Diam.} + 40)}{127}$$

Just think what you can do with a larger box of 40 !

OUR WORK AREA



CableSafe® / Westmark
B.V Arnhemseweg 87
3832 GK Leusden

